

**Aux Sensors
Eng Manual
(22-10-13)
Ver (18.05.14.xx)**

Title Page

© 2003 Comeragh Controls Ltd

No part of this document may be reproduced by any process without the prior written permission from Comeragh Controls Ltd.

The information in this document is provided for reference only. While every effort has been made to make sure it is accurate and complete, Comeragh Controls Ltd does not accept any liability arising out of the application or use of the information or products described herein. Moreover, Comeragh Controls Ltd reserves the right to alter specifications or procedures without notice.

This document may contain or refer to information or products protected by copyright or patents and does not convey any license under the patent rights of Comeragh Controls Ltd nor the rights of others.

All products referred herein are trademarks of their respective owners.

Publication details:

Title: iCon Touch Screen User Manual

Part Number: CC-200TSEM

Produced by:

Product Support Department

Comeragh Controls Ltd

Upper Irish Town

Clonmel

Co. Tipperary

1. Access Engineering Menu

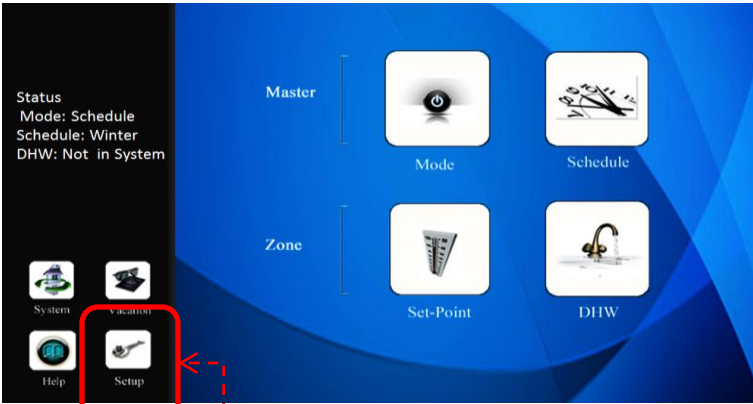

Step 1. Press Setup

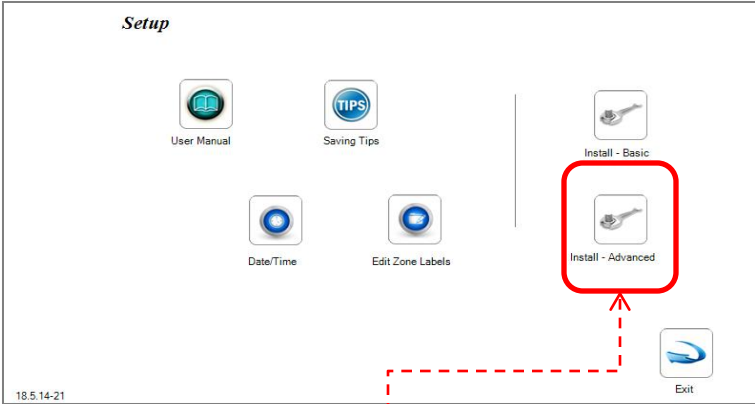

Step 2. Press - Install Advanced

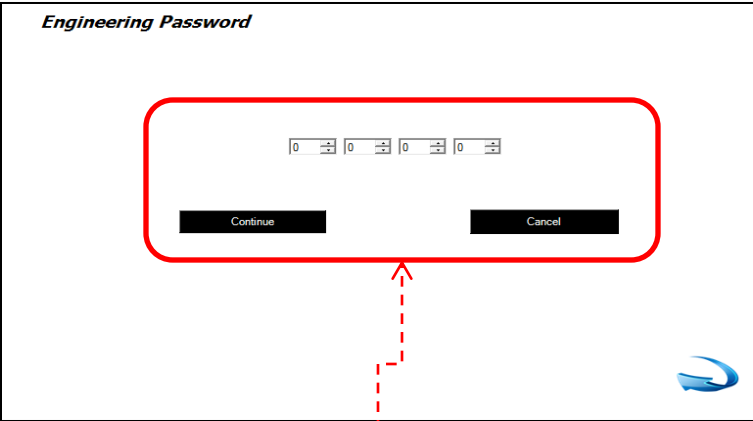

3. Enter code 3105 & Press Continue

2. Engineering Menu – Aux Sensors

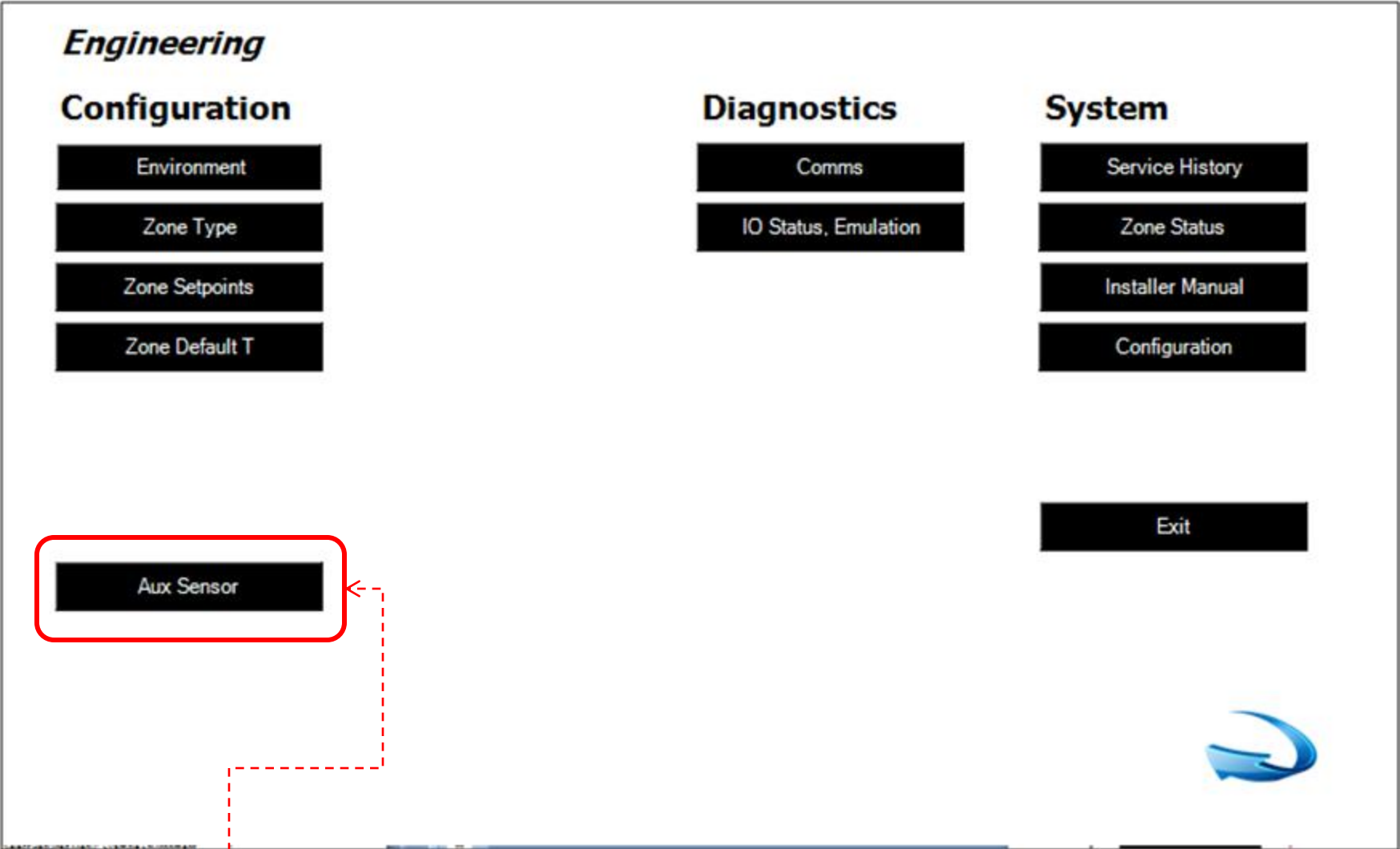

Optional Aux Sensors

3. Aux Sensors

Aux Sensors

Idx	Name	Channel	Set Point #1	Set Point #2	Temp
1	Ch2 - Probe Temperature	Ch2 - Probe Temperature	0	0	0°C
2	Flow_Temp	Ch2 - Probe Temperature	0	0	0°C
3	Flow_Temp	Ch2 - Probe Temperature	0	0	0°C
4	Flow_Temp	Ch2 - Probe Temperature	0	0	0°C
5	Flow_Temp	Ch2 - Probe Temperature	0	0	0°C
6	Flow_Temp	Ch2 - Probe Temperature	0	0	0°C
7	Flow_Temp	Ch2 - Probe Temperature	0	0	0°C
8	Flow_Temp	Ch2 - Probe Temperature	0	0	0°C
9	Flow_Temp	Ch2 - Probe Temperature	0	0	0°C
10	Flow_Temp	Ch2 - Probe Temperature	0	0	0°C

Overview:
The Aux sensors are typically used in conjunction with the 0-10v Proportional Valve (PV)

Typical Application
External Weather Compensation
Cooling flow temperature modulation
Differential temperate control

Aux Sensors	
Idx	Identification Number
Name	External (External Sensor) Flow (Flow Sensor) Ref (Reference Sensor) Temperature (General – Temperature Sensor)
Channel	Ch2 – Probe Temp (Default Reference) Ch1 – Air Temp
Set Point #1 /2	Set Point temp for Ch1 (Air) & Ch2 (Probe)
Temp	Actual measured temp

Comment:
Aux Sensor are typically used in conjunction with the following main Modules

- Advance Configuration
- Configurable 0-10v Modulation (e.g. Cooling)