

**Relay Timers , Cycle
Eng Manual
(22-10-13)
Ver (18.06.01-56)**

Title Page

© 2003 Comeragh Controls Ltd

No part of this document may be reproduced by any process without the prior written permission from Comeragh Controls Ltd.

The information in this document is provided for reference only. While every effort has been made to make sure it is accurate and complete, Comeragh Controls Ltd does not accept any liability arising out of the application or use of the information or products described herein. Moreover, Comeragh Controls Ltd reserves the right to alter specifications or procedures without notice.

This document may contain or refer to information or products protected by copyright or patents and does not convey any license under the patent rights of Comeragh Controls Ltd nor the rights of others.

All products referred herein are trademarks of their respective owners.

Publication details:

Title: iCon Touch Screen User Manual

Part Number: CC-200TSEM

Produced by:

Product Support Department

Comeragh Controls Ltd

Upper Irish Town

Clonmel

Co. Tipperary

1. Access Engineering Menu



Step 1. Press Setup

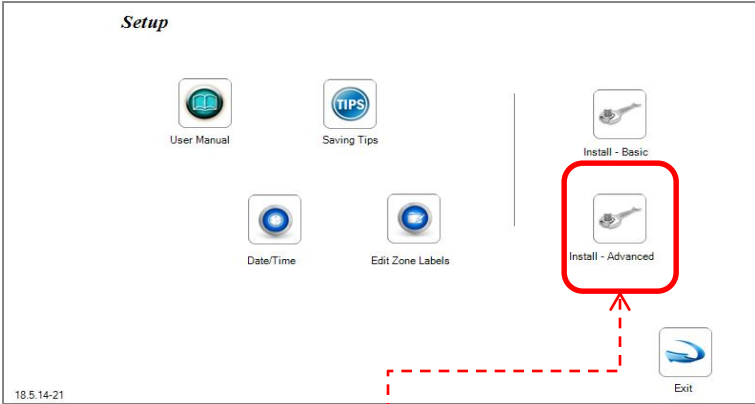

Step 2. Press - Install Advanced

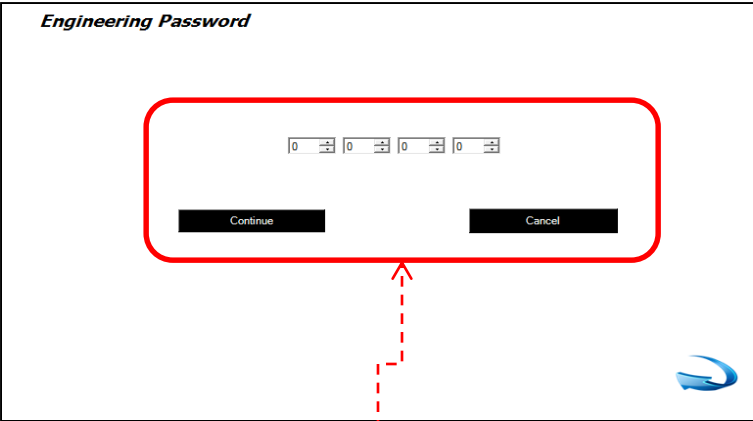

3. Enter code 3105 & Press Continue

2. Engineering Menu – PV (Proportional Valve) (0-10v Modulation)

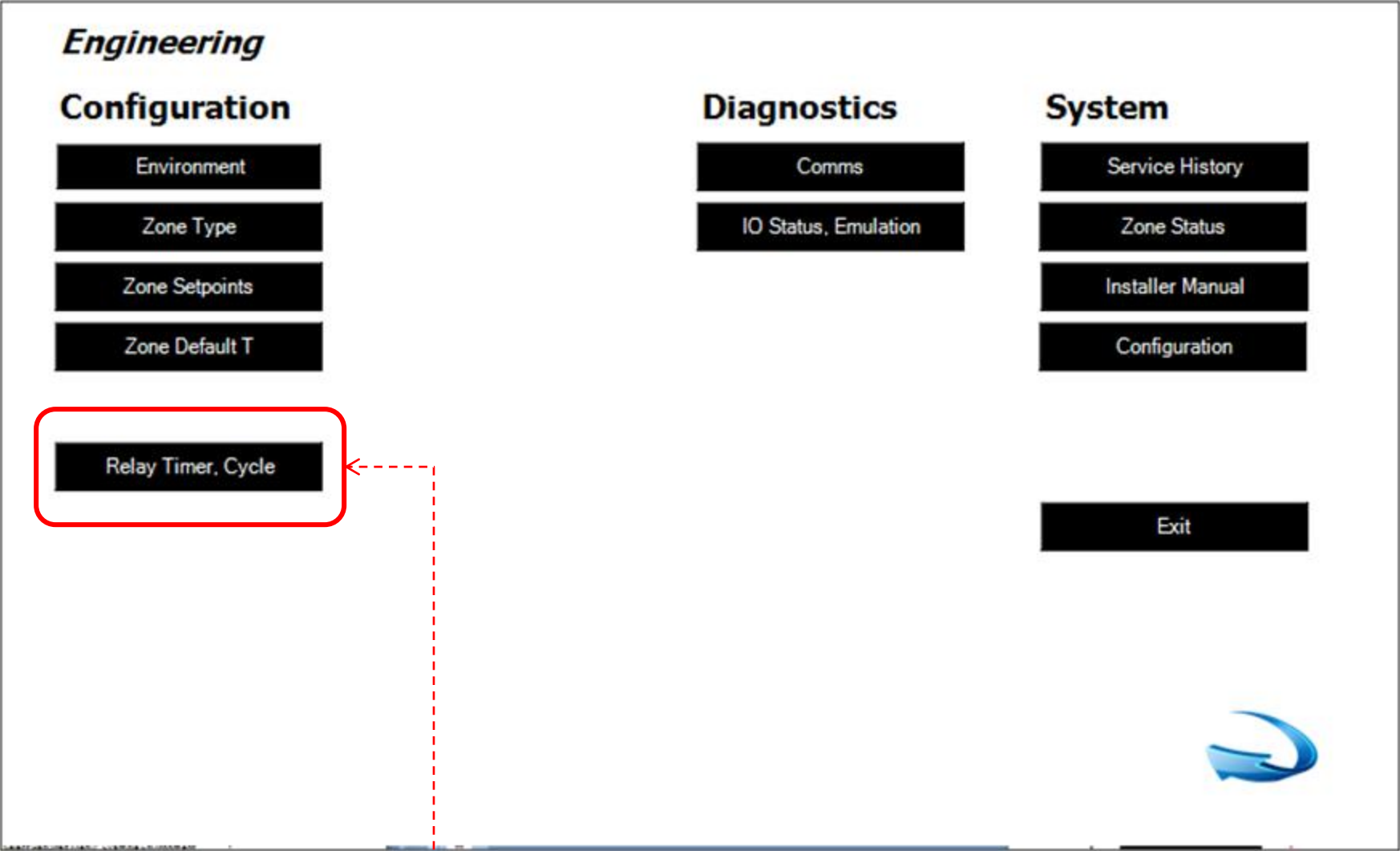

Select Relay Timers , Cycle

3. I/O Timer (Relay Time ON & Overrun & Pump Cycle & Schedule Relay Timer)

#	TOn(min)	TOff(min)	Cy	Tmr	Start(min)	Dur(min)
1	0	0	<input type="checkbox"/>	<input checked="" type="checkbox"/>	155	5
2	0	0	<input type="checkbox"/>	<input checked="" type="checkbox"/>	175	10
3	0	0	<input type="checkbox"/>	<input checked="" type="checkbox"/>	195	15
4	0	0	<input type="checkbox"/>	<input checked="" type="checkbox"/>	215	20
5	0	0	<input type="checkbox"/>	<input checked="" type="checkbox"/>	235	25
6	0	0	<input type="checkbox"/>	<input type="checkbox"/>	0	0
7	0	0	<input type="checkbox"/>	<input type="checkbox"/>	0	0
8	0	0	<input type="checkbox"/>	<input type="checkbox"/>	0	0

#	TOn(min)	TOff(min)	Cy	Tmr	Start(min)	Dur(min)
9	0	0	<input type="checkbox"/>	<input type="checkbox"/>	0	0
10	0	0	<input type="checkbox"/>	<input type="checkbox"/>	0	0
11	0	0	<input type="checkbox"/>	<input type="checkbox"/>	0	0
12	0	0	<input type="checkbox"/>	<input type="checkbox"/>	0	0
13	0	0	<input type="checkbox"/>	<input type="checkbox"/>	0	0
14	0	0	<input type="checkbox"/>	<input type="checkbox"/>	0	0
15	0	0	<input type="checkbox"/>	<input type="checkbox"/>	0	0
16	0	0	<input type="checkbox"/>	<input type="checkbox"/>	0	0

Cycle Interval (hrs): 336 Cycle Duration (Mins): 2

I/O #1 ✓ I/O #2 x I/O #3 x I/O #4 x
I/O #5 x I/O #6 x I/O #7 ? I/O #8 x

Timer ON (Delay) & Off (Overrun)

Relay 1-8 and 9-16
Time ON 1-99 min
Overrun 1-99 min

Schedule Relay Activation Timer

Individual Time & Duration for all relays
Enable must be selected – beside applicable Relay #

Timer Interval : Set Activation Start Time e.g. 2:35 =155min
Start (Min) Note: Timer Routine time start at hr change over

Timer Duration: Set the Duration time period e.g. 20 = 20 min
Dur (Min) Max Duration 99min (+/-30sec system propagation)

Tmr Must Be Checked to apply Sch-Cy

Note: (a) Time ON & OFF Delays ignored
(b) Activations Ignored
(c) Relay # Display in RED when Active (Advanced Config)
(d) If relay has been on before - ignored

Select I/O 1-8

I/O Cycle Interval (Pump Cycle Routine- If device has not been active)

Relay 1-8 and 9-16
Enable must be selected – beside applicable Relay #
Cycle Interval : (Hrs) Set interval time between cycle s
Cycle Duration : (Min) Set the ON time cycle period e.g. 20 = 20 min
Note: Cycle Routine time start at hr change over
Time on & off Delays are still in operation